

NOTES: UNLESS OTHERWISE SPECIFIED

1. APPLICABLE STANDARDS AND SPECIFICATIONS:
 - ASME.Y14.5.DIMENSIONING.AND.TOLERANCING.2009
2. MATERIAL: ALUMINIUM 6061 T6
3. FINISH: -
4. REMOVE ALL SHARP EDGES AND BURRS .005 TO .020.

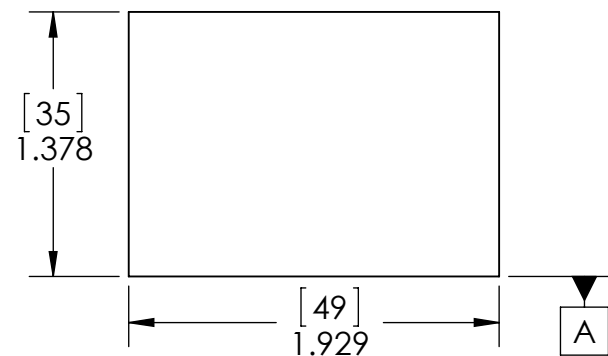
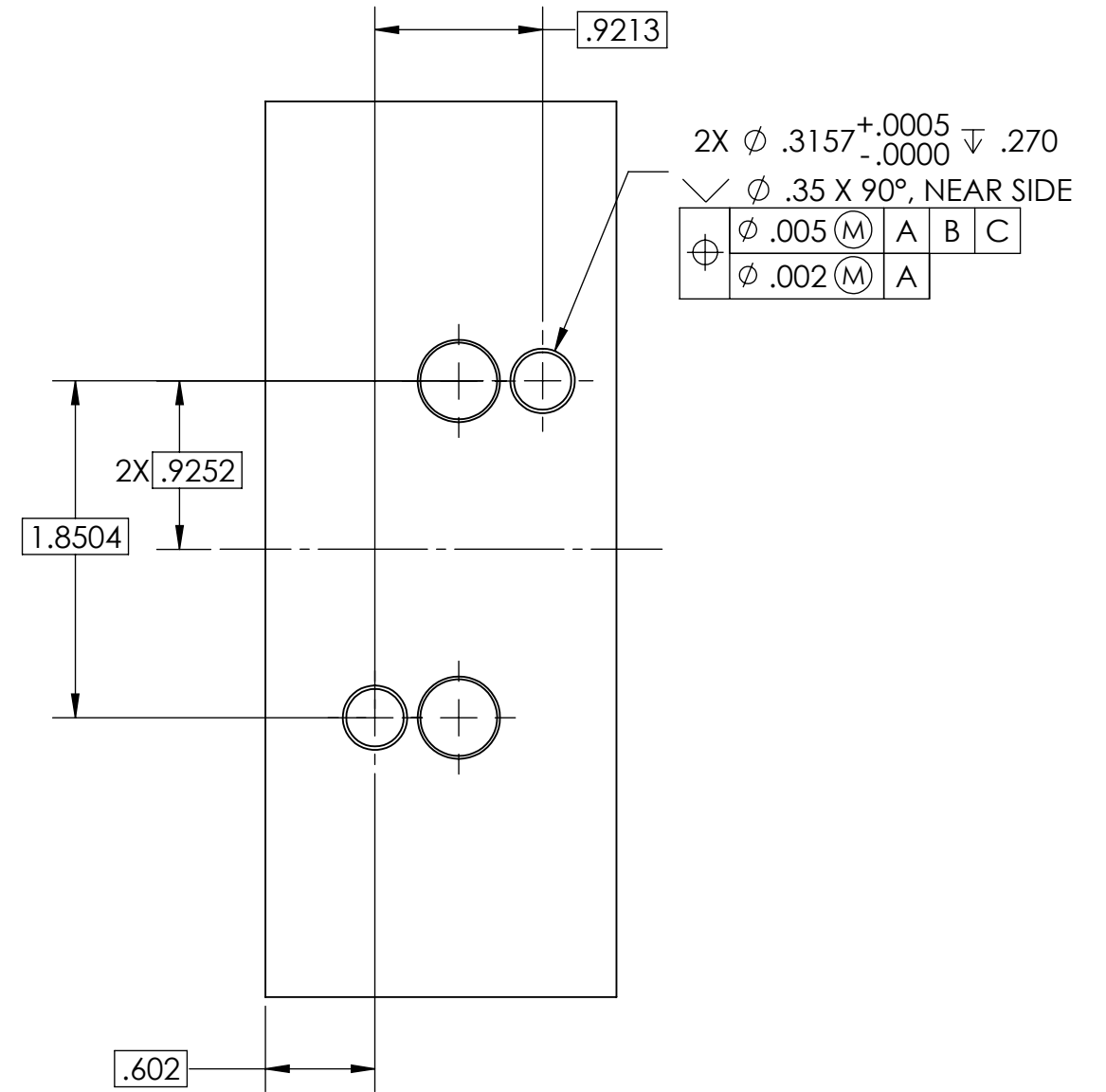
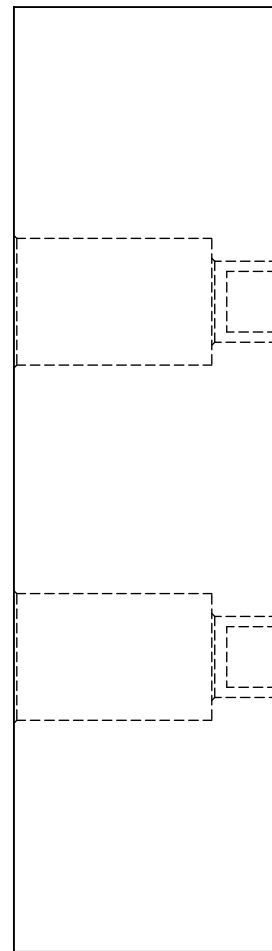
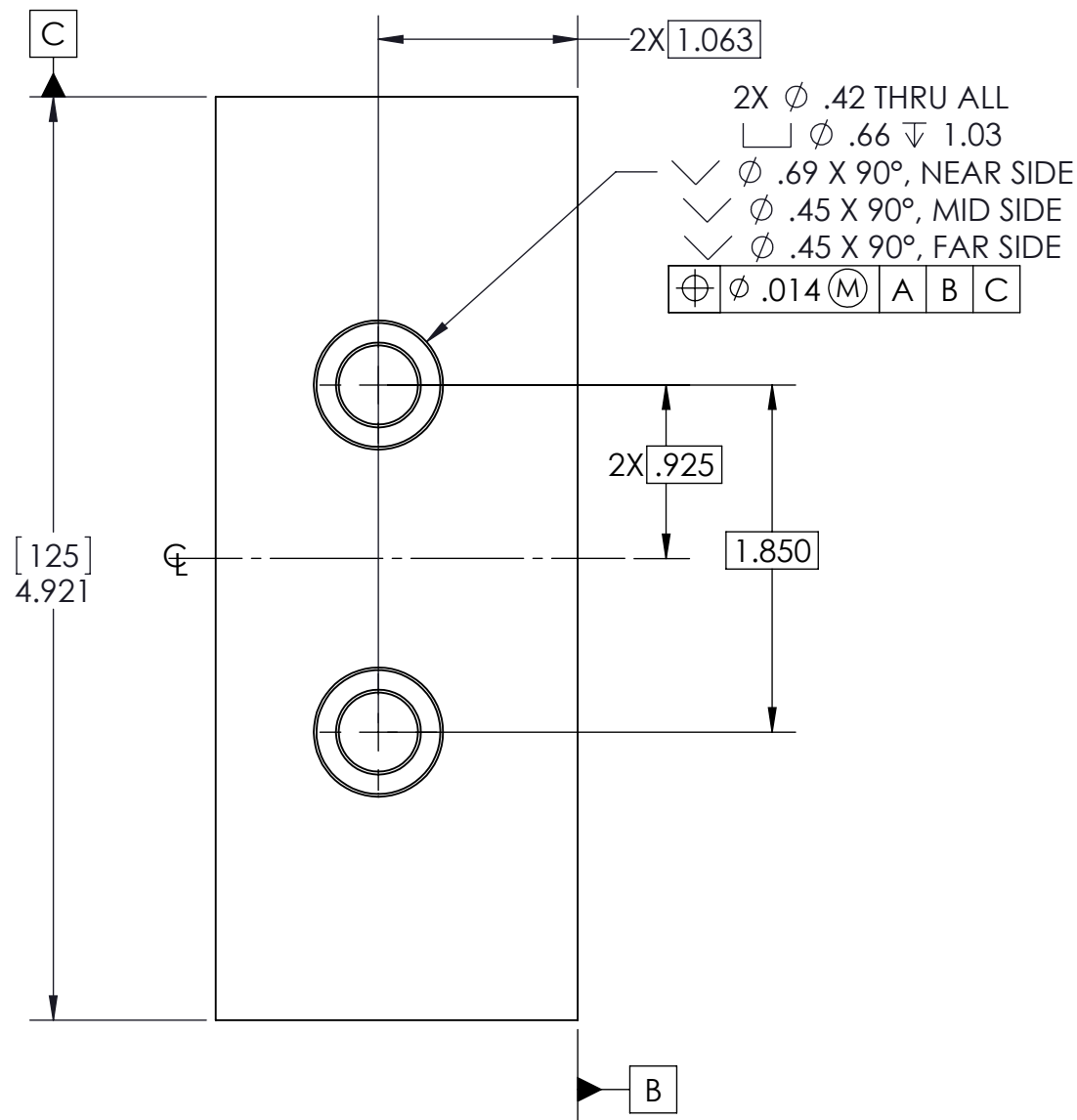

TOLERANCES	
METRIC	INCH
X \pm 1.0	X \pm 0.1
.X \pm 0.3	.X \pm 0.05
.XX \pm 0.13	.XX \pm 0.01
	.XXX \pm 0.005
UNLESS OTHERWISE NOTED	
ANGULAR DIMENSIONS \pm 0.5°	

INCH
PROPRIETARY AND CONFIDENTIAL
 THE INFORMATION CONTAINED IN THIS DRAWING IS THE SOLE PROPERTY OF FIFTH AXIS, INC. ANY REPRODUCTION IN PART OR AS A WHOLE WITHOUT THE WRITTEN PERMISSION OF FIFTH AXIS, INC. IS PROHIBITED.

APPROVALS
 DRAWN BY: DANM. 2/13/2015
 MFG. ENG.
 QA ENG.
 ENG. MGR: CHRIS T. 2/13/2015
 MATERIAL: 2
 FINISH: 3
 WEIGHT: 1.194 LBS

5thAXIS
 7140 ENGINEER ROAD, SAN DIEGO, CA 92111
 PH (858) 505-0432 FX (858) 505-0432

CUSTOMER
 DESCRIPTION: ALUMINIUM SOFT JAW, V562M VISE
 SIZE: B PART NO. VAJ52M
 DO NOT SCALE DRAWING SCALE 1:1 SHEET 1 OF 1