

NOTES:

- 1. DOVETAIL WIDTH WILL NOT CHANGE WITH VARYING DOVETAIL DEPTH
- 2. MACHINE EDGE BREAK ON DOVETAIL POINT
- 3. IF STOCK IS OVERSIZED, THE TOLERANCE IS INCREASED BY HALF THE EXTRA STOCK

DM50 DOVETAIL STOCK PREPARATION

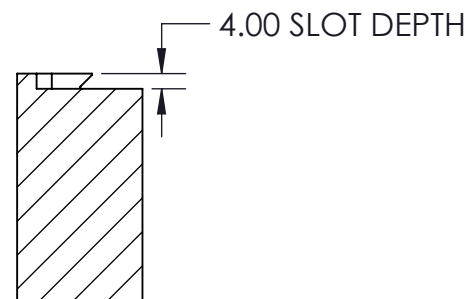
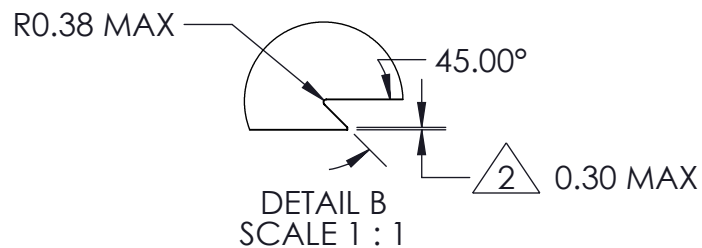
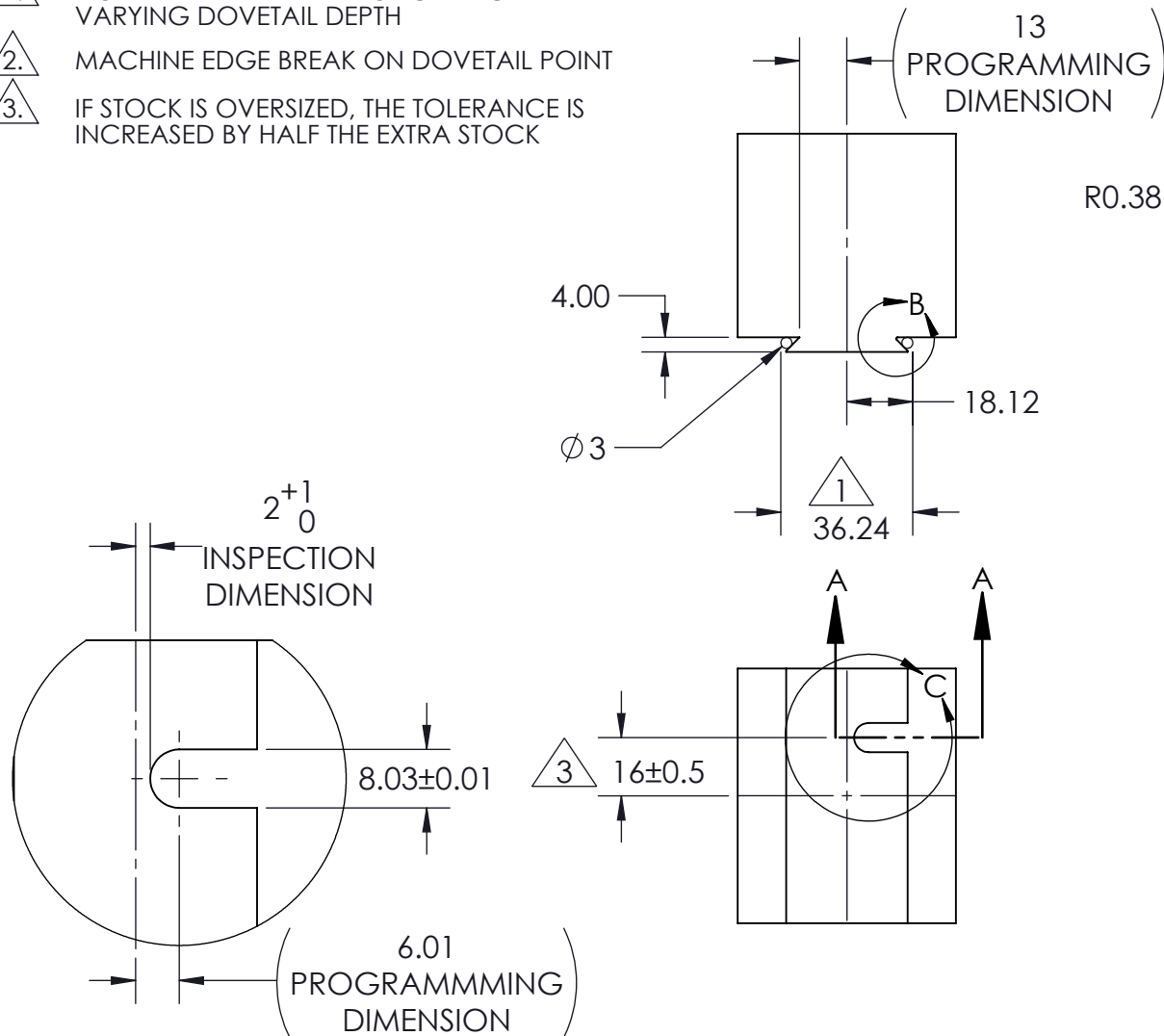

DETAIL C SCALE 1:1

SECTION A-A

MILLIMETER <small>DRAWN IN ACCORDANCE WITH ASME Y14.5-2009</small> PROPRIETARY AND CONFIDENTIAL <small>THE INFORMATION CONTAINED IN THIS DRAWING IS THE SOLE PROPERTY OF FIFTH AXIS, INC. ANY REPRODUCTION IN PART OR AS A WHOLE WITHOUT THE WRITTEN PERMISSION OF FIFTH AXIS, INC. IS PROHIBITED.</small>	TOLERANCES <small>UNLESS OTHERWISE SPECIFIED</small> X ± 1.0 .X ± 0.3 ANGLULAR ± 0.5° .XX ± 0.13	APPROVALS DRAWN BY Gilles M. 9/19/2017 MANUFACTURING - QUALITY - FINAL -			WWW.FIFTHAXIS.COM 7140 ENGINEER ROAD SAN DIEGO, CA 92111 P (858) 505-0432 F (858) 505-9344
	<small>THRID ANGLE PROJECTION</small> 	DESCRIPTION DM50 DOVETAIL STOCK PREP			
		SIZE A PART NO. DSP-DM25	DO NOT SCALE DRAWING	SCALE 1:2	WEIGHT:
		REV A	SHEET 1 OF 1		