

TECHNICAL DATA	V75100X
JAW LENGTH	75 MM
MAXIMUM CLAMPING FORCE	AT MAX TORQUE OF 60NM, 13.5KN
CLAMPING RANGE STANDARD	0-40MM
CLAMPING RANGE REVERSED	40-77MM
SELF-CENTERING ACCURACY	±.013MM

V75100X

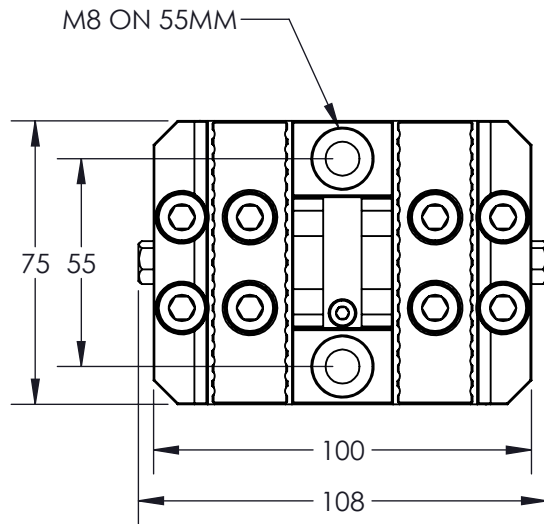

3X $\square \phi 8.005 \nabla .16$
 $\phi 8.000$
 M5X0.8 $\nabla 10$
FITS LP8

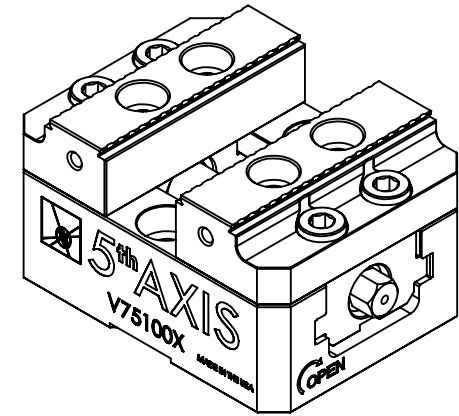
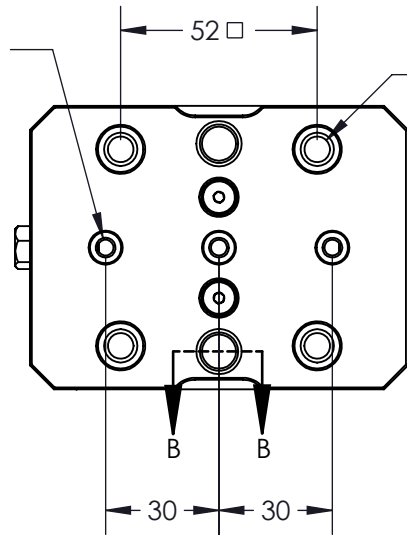

4X $12.02 \nabla 6$
 12.00
 M8X1.25 $\nabla 16$
FITS PS16F

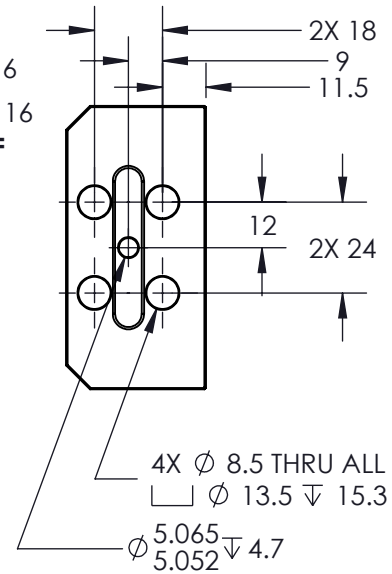

JAW MOUNTING

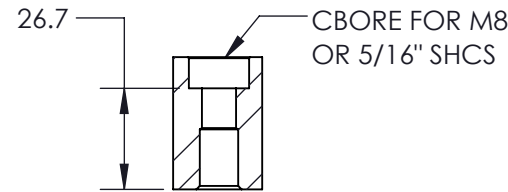
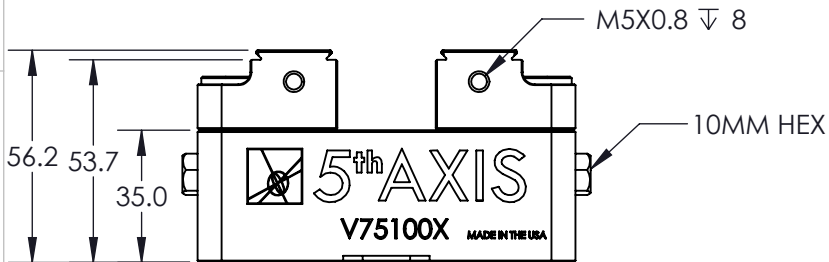

SECTION B-B

MILLIMETER	TOLERANCES
UNLESS OTHERWISE SPECIFIED	
DRAWN IN ACCORDANCE WITH ASME Y14.5-2009	X ± 0.1 XX ± 0.01
PROPRIETARY AND CONFIDENTIAL	X ± 0.05 XXX ± 0.005
THIRD ANGLE PROJECTION	ANGULAR ± 0.5°
THE INFORMATION CONTAINED IN THIS DRAWING IS THE SOLE PROPERTY OF FIFTH AXIS, INC. ANY REPRODUCTION IN PART OR AS A WHOLE WITHOUT THE WRITTEN PERMISSION OF FIFTH AXIS, INC. IS PROHIBITED.	



WWW.5THAXIS.COM
 7140 ENGINEER ROAD
 SAN DIEGO, CA 92111
 P (858) 505-0432 F (858) 505-9344

DESCRIPTION	SIZE	PART NO.	REV
WISE, 75MM X 100MM, SELF-CENTERING	A	V75100X	A
DO NOT SCALE DRAWING	SCALE 1:1	WEIGHT: 2.3 KG	SHEET 1 OF 1